

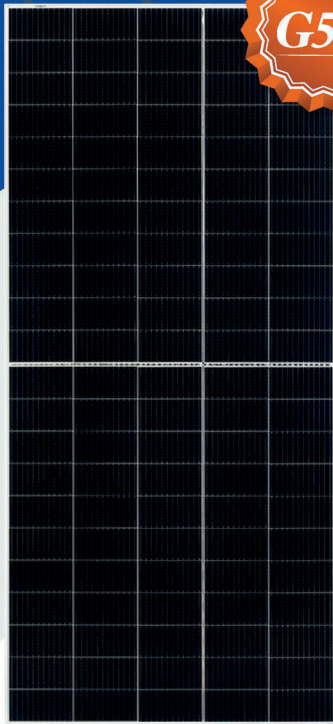

## HIGH PERFORMANCE MONOCRYSTALLINE PERC MODULE



**G5.6**

888

### RSM110-8-530M-550M

**110 CELL**

Mono PERC Module

**530-550Wp**

Power Output Range

**1500VDC**

Maximum System Voltage

**21.0%**

Maximum Efficiency

### KEY SALIENT FEATURES



Global, Tier 1 bankable brand, with independently certified state-of-the-art automated manufacturing



Industry leading lowest thermal co-efficient of power



Industry leading 12 years product warranty



Excellent low irradiance performance



Excellent PID resistance



Positive tight power tolerance



Dual stage 100% EL Inspection warranting defect-free product



Module Imp binning radically reduces string mismatch losses



Excellent wind load 2400Pa & snow load 5400Pa under certain installation method



Comprehensive product and system certification

- ◆ IEC61215:2016; IEC61730-1/-2:2016;
- ◆ ISO 9001:2015 Quality Management System
- ◆ ISO 14001:2015 Environmental Management System
- ◆ ISO 45001:2018 Occupational Health and Safety Management System



\*As there are different certification requirements in different markets, please contact your local MEGA SOLAR sales representative for the specific certificates applicable to the products in the region in which the products are to be used.

### MEGA SOLAR

MEGA SOLAR is a leading, global tier 1 manufacturer of high-performance solar photovoltaic products and provider of total business solutions for residential, commercial and utility-scale power generation. The company, founded in 1986, and publicly listed in 2010, compels value generation for its chosen global customers. Techno-commercial innovation, underpinned by consummate quality and support, encircle MEGA SOLAR's total Solar PV business solutions which are among the most powerful and cost-effective in the industry. With local market presence and strong financial bankability status, we are committed, and able, to building strategic, mutually beneficial collaborations with our partners, as together we capitalise on the rising value of green energy.

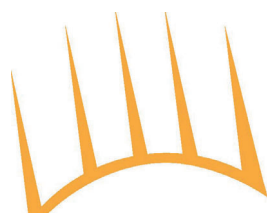

MEGA SOLAR

### LINEAR PERFORMANCE WARRANTY

12 year Product Warranty / 25 year Linear Power Warranty

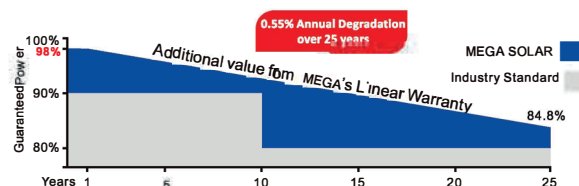

THE POWER OF MEGA SOLAR VALUE

### Dimensions of PV Module Unit: mm

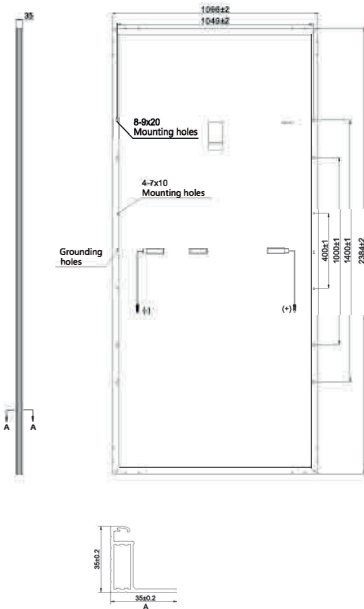

### ELECTRICAL DATA (STC)

Model Number	RSM110-8-530M	RSM110-8-535M	RSM110-8-540M	RSM110-8-545M	RSM110-8-550M
Rated Power in Watts-Pmax(Wp)	<b>530</b>	<b>535</b>	<b>540</b>	<b>545</b>	<b>550</b>
Open Circuit Voltage-Voc(V)	37.38	37.58	37.78	38.02	38.24
Short Circuit Current-Isc(A)	18.08	18.13	18.18	18.23	18.28
Maximum Power Voltage-Vmpp(V)	31.06	31.26	31.46	31.66	31.86
Maximum Power Current-Imp(A)	17.07	17.12	17.17	17.22	17.27
Module Efficiency (%) *	20.3	20.5	20.7	20.9	21.0

STC: Irradiance 1000 W/m<sup>2</sup>, Cell Temperature 25°C, Air Mass AM1.5 according to EN 60904-3.

\* Module Efficiency (%): Round-off to the nearest number

### ELECTRICAL DATA (NMOT)

Model Number	RSM110-8-530M	RSM110-8-535M	RSM110-8-540M	RSM110-8-545M	RSM110-8-550M
Maximum Power-Pmax (Wp)	401.5	405.3	409.0	412.8	416.7
Open Circuit Voltage-Voc (V)	34.76	34.95	35.14	35.36	35.56
Short Circuit Current-Isc (A)	14.83	14.87	14.91	14.95	14.99
Maximum Power Voltage-Vmpp (V)	28.82	29.01	29.19	29.38	29.57
Maximum Power Current-Imp (A)	13.93	13.97	14.01	14.05	14.09

NMOT: Irradiance at 800 W/m<sup>2</sup>, Ambient Temperature 20°C, Wind Speed 1 m/s.

### MECHANICAL DATA

Solar cells	Monocrystalline
Cell configuration	110 cells (5×11+5×11)
Module dimensions	2384×1096×35mm
Weight	29kg
Superstrate	High Transmission, Low Iron, Tempered ARC Glass
Substrate	White Back-sheet
Frame	Anodized Aluminium Alloy type 6005-2T6, Silver Color
J-Box	Potted, IP68, 1500VDC, 3 Schottky bypass diodes
Cables	4.0mm <sup>2</sup> (12AWG), Positive(+)350mm, Negative(-)350mm (Connector Included)
Connector	Risen Twinsel PV-SY02, IP68

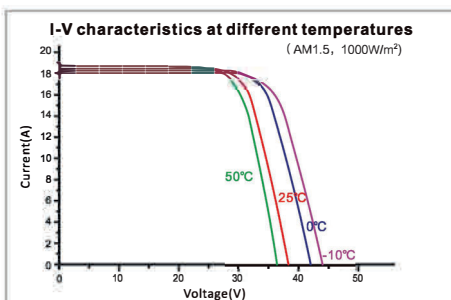
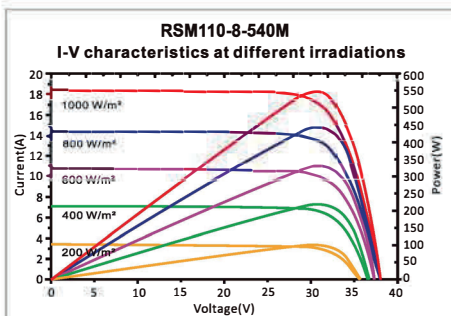

### TEMPERATURE & MAXIMUM RATINGS

Nominal Module Operating Temperature (NMOT)	44°C±2°C
Temperature Coefficient of Voc	-0.25%/°C
Temperature Coefficient of Isc	0.04%/°C
Temperature Coefficient of Pmax	-0.34%/°C
Operational Temperature	-40°C~+85°C
Maximum System Voltage	1500VDC
Max Series Fuse Rating	30A
Limiting Reverse Current	30A

### PACKAGING CONFIGURATION

	40ft(HQ)
Number of modules per container	620
Number of modules per pallet	31
Number of pallets per container	20
Packaging box dimensions (LxWxH) in mm	2401×1115×1235
Box gross weight[kg]	950